

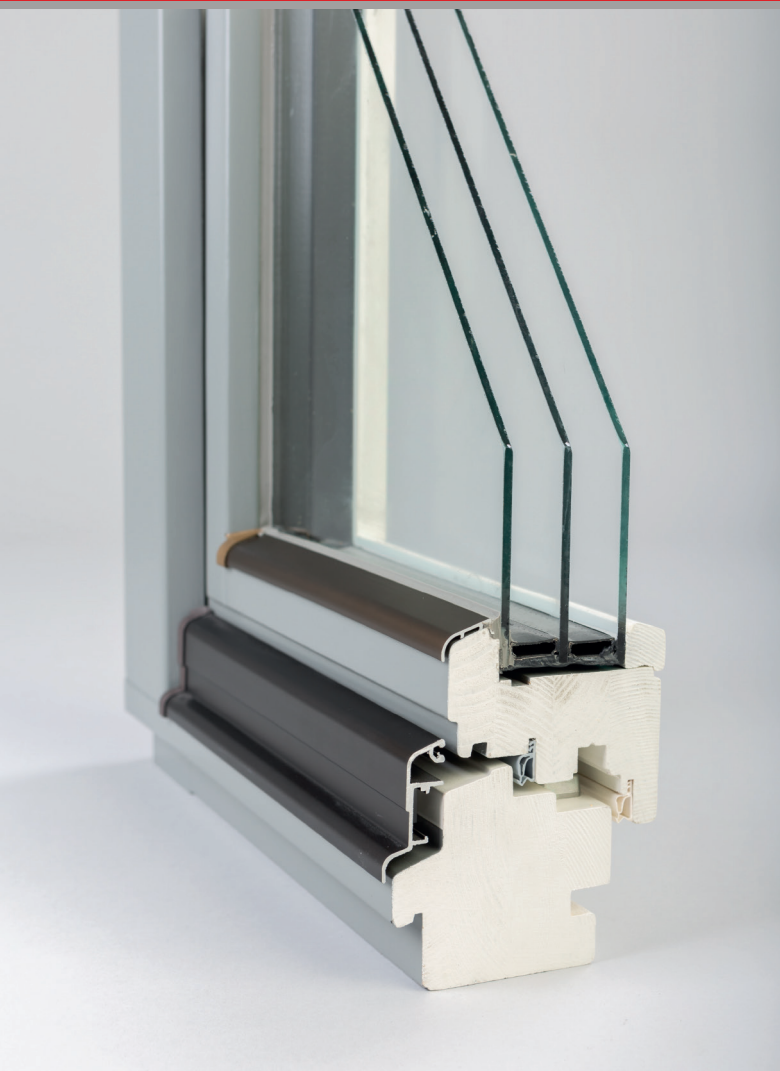

WINDOWSFACTORY
INNOVATIVE MANUFACTURER

→ IV90 WOODEN WINDOW



Inward opening window profile system developed in Germany. The window system has excellent thermal and sound insulation properties, high durability against rain and wind loads, high airtightness.

Frame and sash materials

Length jointed pine.

Also available: American Oak, Sapelli, Meranti, Siberian Larch etc.

Frame and sash thickness (embedment depth)

90mm

With and without the internal and external windowsill groove.

Glazing

24 mm - 52 mm thick glass packets.

Fittings

ROTO, Siegenia. Safety class up to RC3. Hidden and visible fittings.

Sash weight up to 300 kg and height up to 3 m.

Handles – ROTO, Hoppe, Fab&Fix, FSB, Greenteq etc.

Finishing

Standard 20 lacquer shades and coating colours according to RAL and NCS catalogues. The finishing materials are eco-friendly and water-based.

Manufacturers – Sikkens and Teknos.

Aluminium drain gutter

Manufacturer – Aluron, Gutmann and BUG.

Six standard shades available.

Material – aluminium.

Additional

Ventilation valves, child safety and alarm systems.

Window heat transfer U_w coefficient
(window size 1230x1480 and TGI gasket)

Glazing W/(m ² K)		Pine	Oak	Sound insulation
4/20/4/20/4	U _g =0,5	0,83	0,90	34dB
	U _g =0,6	0,89	0,96	33dB



SIA "WINDOWS FACTORY"
WWW.WINDOWSFACTORY.LV
export@windowsfactory.lv



WINDOWSFACTORY
INNOVATIVE MANUFACTURER

PRODUCTION OF WOODEN WINDOWS

→ IV90 WOODEN WINDOW

1-1

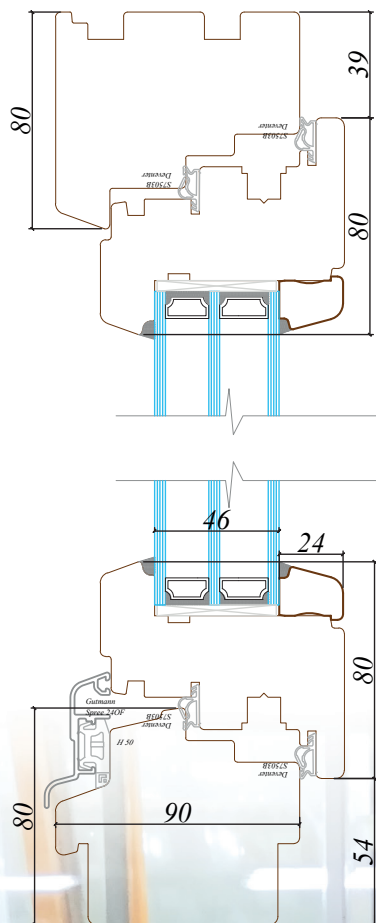

2-2

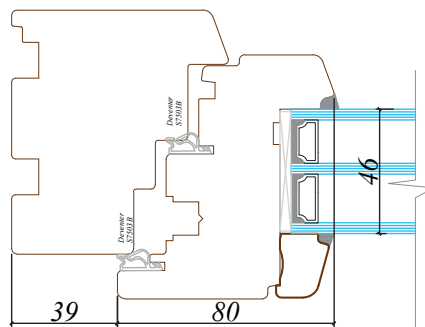

4-4

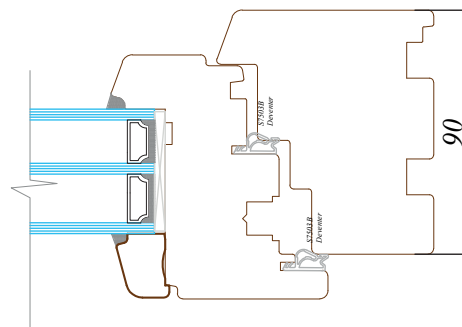

3-3

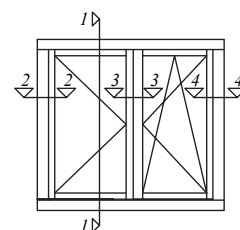
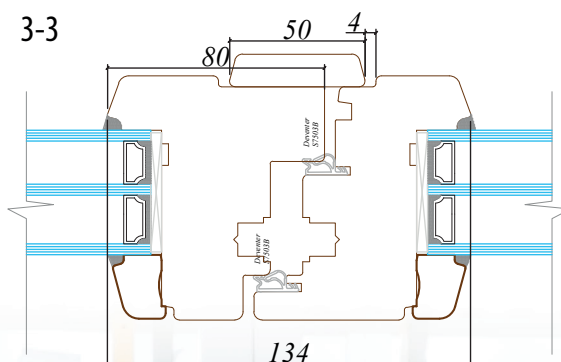

SIA "WINDOWS FACTORY"
WWW.WINDOWSFACTORY.LV
export@windowsfactory.lv